

## CHECK CONDITION OF SHIPMENT

Upon receipt of this kit, check the condition of the packaging. Damage to the package should be noted on the carrier's freight receipt. Any damage claims as a result of shipping must be handled through the shipper. Travis Industries will provide assistance in resolving shipping claims or replacing items not included in the package. Please report any missing items immediately.

## COMPATIBILITY

- DVS Fireplace
- DVL Fireplace
- FPX 36 DV
- FPX 44 XXL
- 35 CB

## ITEMS NEEDED FOR ASSEMBLY

- Phillips Screwdriver (small & medium sized)
- Wire Stripper
- Plastic Junction Box
- Junction Box (with mounting hardware & screws for receiver)
- Additional tools for laying thermostat wire

## PACKING LIST

- Remote Receiver
- Remote Control
- Cover Plate (with 2 screws)
- Cover Plate
- Thermostat Wire (25')
- 4 AA Batteries (for remote receiver)
- 3 AAA Batteries (for remote control)

## FCC EQUIPMENT REQUIREMENTS

Warning: Changes or modifications to this unit not expressly approved by the party responsible for compliance could void the user's authority to operate the equipment. This equipment has been tested and found to comply with the limits for a Class B digital device, pursuant to Part 15 of the FCC Rules. These limits are designed to provide reasonable protection against harmful interference in a residential installation. This equipment generates, uses, and can radiate radio frequency energy and, if not installed and used in accordance with the instructions, may cause harmful interference to radio communications. However, there is no guarantee that interference will not occur in a particular installation. If this equipment does cause harmful interference to radio or television reception, which can be determined by turning the equipment off and on, the user is encouraged to try to correct the interference by one or more of the following measures:

- Reorient or relocate the receiver.
- Increase the separation between the equipment and receiver.
- Connect the equipment into an outlet on a circuit different from that to which the receiver is connected.
- Consult the dealer or an experienced radio TV technician for help.

## CANADIAN EQUIPMENT REQUIREMENTS

This digital apparatus does not exceed the (Class A/Class B) limits for radio noise emissions from digital apparatus set out in the Radio Interference Regulations of the Canadian Department of Communications. Le present appareil numerique n'emet pas de bruits radioelectriques depassant les limites applicables aux appareils numeriques (de la class A/de la class B) prescrites dans le Reglement sur le brouillage radioelectrique edicte par le ministere des Communications du Canada.

This device complies with RSS-210 of Industry and Science Canada. Operation is subject to the following two conditions: (1) this device may not cause interference, and (2) this device must accept any interference, including interference that may cause undesired operation of the device.

## INSTALLATION WARNINGS

- ! Never install the remote receiver inside the fireplace - the electronics will become too hot and degrade.
- ! All 110 AC wiring must be done by a qualified electrician and shall be in compliance with local codes and the National Electric Code ANSW/NFPA no. 70 (in the United States) or with the current CSA C22.1 Canadian Electric Code (in Canada).
- ! This kit must be installed by a qualified technician.
- ! Do not connect 110 VAC to the gas control valve or on/off switch on gas heaters or the thermostat posts on pellet heaters.
- ! The remote control is carefully engineered and MUST be installed only as specified. It is tested safe when installed in accordance with this installation manual. If you modify it or any of its components, you may possibly cause a fire hazard. It is your responsibility to read all instructions before starting installation and to follow these instructions carefully during installation.
- ! Turn off the gas supply to the fireplace before installing the remote control.



**TRAVIS INDUSTRIES  
HOUSE OF FIRE**

10850 117th Place N.E. Kirkland, WA 98033

## INSTALLATION INSTRUCTIONS

- 1 Access the back of the on/off switch on the fireplace. Attach the thermostat wire to the heater as shown below.

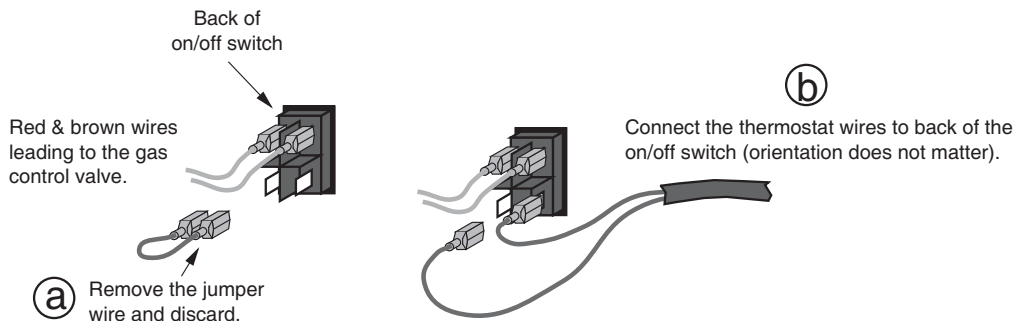

- 2 Mount a junction box for the remote receiver. It should be within 25' of the fireplace and easy to access. Route the thermostat wire from the fireplace and through the back of the junction box.

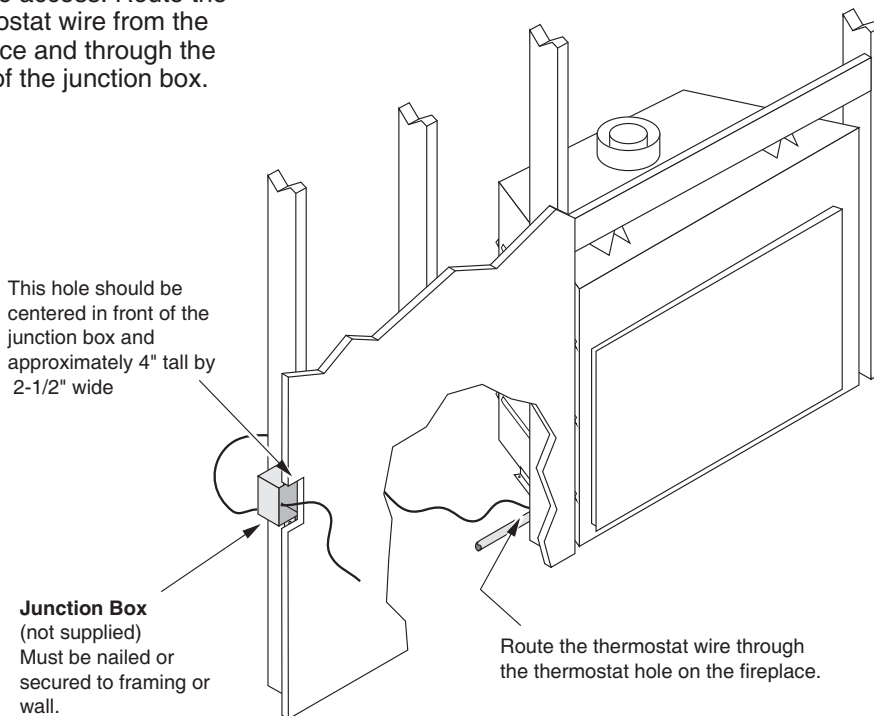

**TRAVIS INDUSTRIES  
HOUSE OF FIRE**

10850 117th Place N.E. Kirkland, WA 98033

- Remove the switch and cover plate from the receiver. Insert the remote receiver into the junction box, making sure the wire does not pull loose or become damaged. Attach the remote receiver to the junction box (these screws are not included). Attach the cover plate to the receiver with the two screws included. Replace the switch.

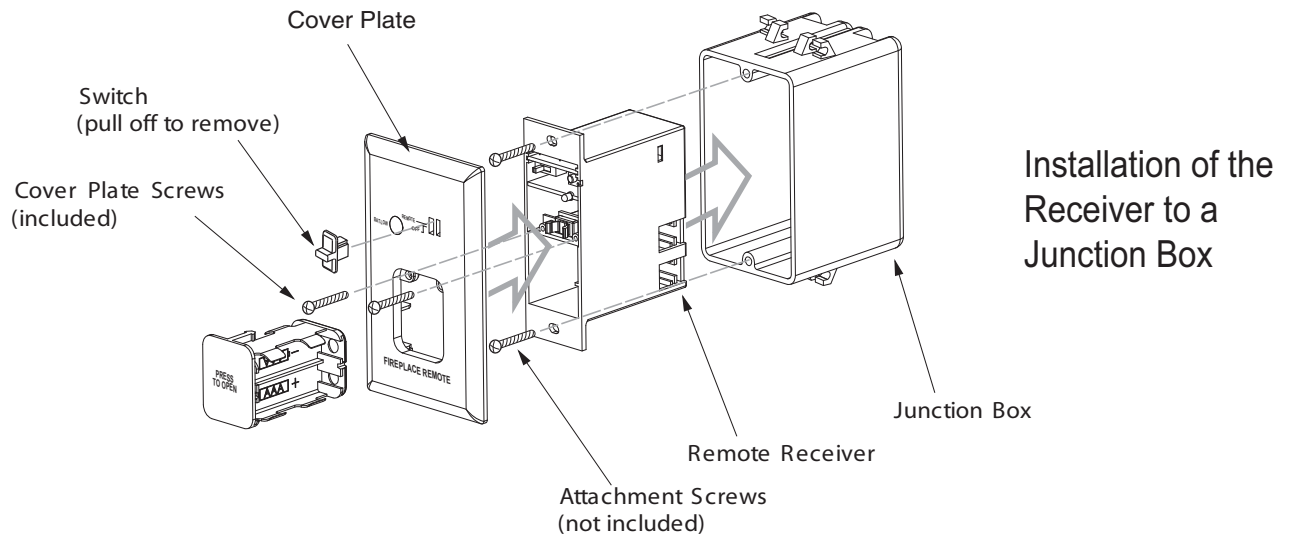

- Install batteries into the receiver following the directions below.

**(a)** Press on the battery pack to release it.

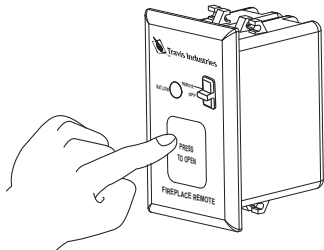

**(b)** Pull the battery pack away from the cover plate.

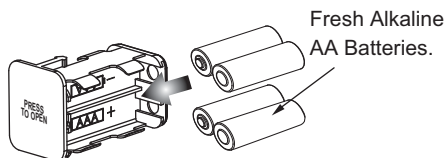

**(c)** Insert four "AA" batteries into the battery pack. Re-assemble the battery pack and slide it back into place (it will "click" when fully in place).

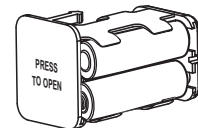

**TRAVIS INDUSTRIES  
HOUSE OF FIRE**

10850 117th Place N.E. Kirkland, WA 98033

## Remote Receiver Calibration

- 1 Remove the cover from the back of the transmitter. Slide the code switches to a random position on the transmitter. Insert three "AAA" batteries into the transmitter as shown.
- 2 Plug in the receiver. Position the transmitter within 2-5 feet of the receiver. Press down any button on the transmitter until the receiver "beeps". This indicates the transmitter and receiver are calibrated on the same radio frequency (if it does not, remove batteries, replace, and repeat this process). Test operation of the remote control.

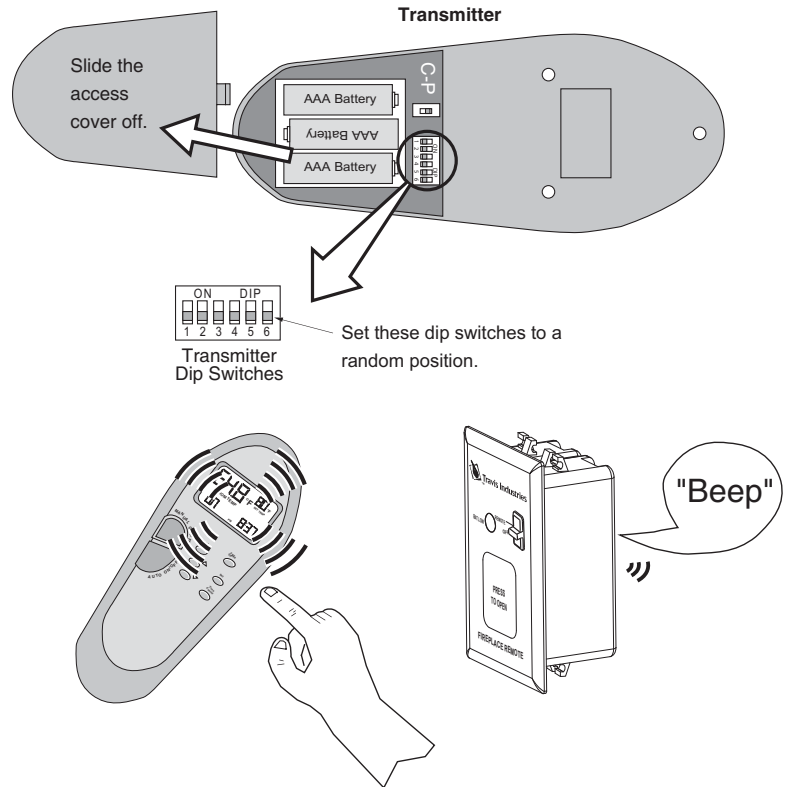

## SETTING THE TIME:

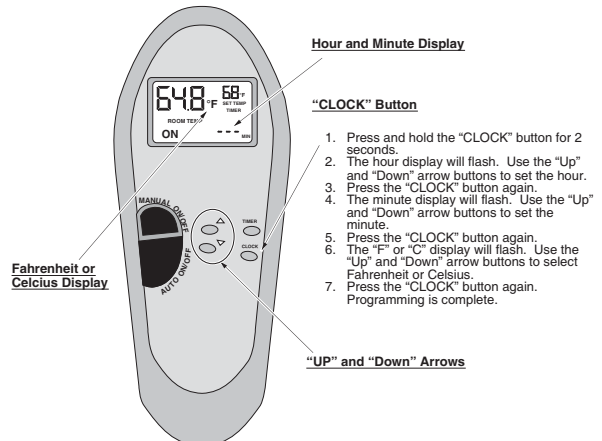

## WALL SWITCH OPERATION:

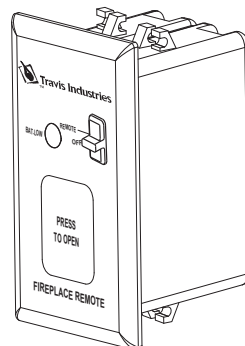

The wall switch can be used to over-ride the remote thermostat. Move the switch to the "ON" position to turn the fireplace on, to the "OFF" position to turn the fireplace off. To use the remote, make sure the wall switch is in the "REMOTE" position.

## OPERATING INSTRUCTIONS

- NOTE :** This kit must be installed by a qualified technician to work correctly
- NOTE :** The pilot flame must be lit, the gas control valve turned to "ON", and the on/off switch turned to "OFF" for the remote to work correctly.
- NOTE :** The remote must be calibrated before it will work (see the instructions on the previous page). If the remote fails to work, try unplugging the remote receiver, plugging it back in, then re-calibrate the remote.

## MODES OF OPERATION:

### 6HR Safety Timer(FACTORY SETTING IS "ON")

#### Enable - Timer Set to "ON"

In case of Transmitter failure (Mal-function / Battery run out) or out of transmission range, The Receiver will shut down the fireplace automatically after 6Hr of no Transmitter signal detection.

#### Disable - Timer Set to "OFF"

The Receiver & Fireplace will continue operate in the last setting and will not shut off automatically even in case of Transmitter failure. (Note: Not recommended)

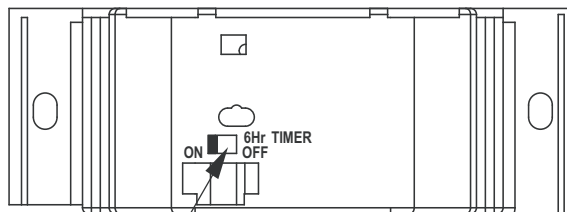

	First 2Hr since last signal received	Following 4Hr	6 <sup>th</sup> Hr since last signal received
Receiver/Fireplace Status	ON	Intermittent and Check For Transmitter Signal	Shut down if no signal received

## Auto Mode

Auto mode works like a thermostat, turning the heater on and off to meet the desired temperature.

### THERMOSTAT MODE:

Use this key to toggle the thermostat mode. The display will indicate "AUTO" when in thermostat mode.

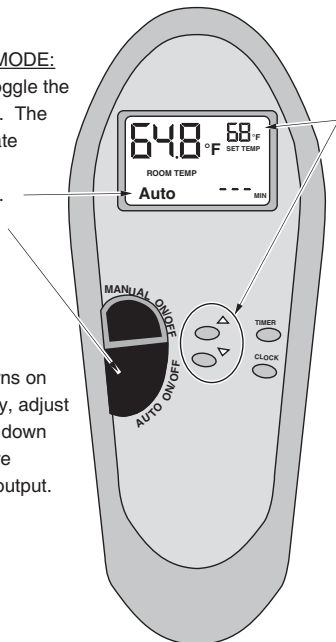

**HINT:**  
If your heater turns on and off frequently, adjust the flame height down slightly for a more consistent heat output.

### TO ADJUST TARGET

#### TEMPERATURE:

Use the arrow keys to adjust the target temperature to the desired level.

The heater will turn on and off to keep the room temperature near the target temperature.

### IMPORTANT NOTES:

- The thermostat has a delay to prevent the heater from turning on and off repeatedly. As a result, the target temperature may be slightly higher (2° or 3°) than the room temperature yet the heater does not turn on – do not adjust the target temperature – the heater will turn on in a few minutes.
- The thermostat is not intended for un-attended use. If the thermostat calls for heat for 6 hours continuously, it will shut off and not turn on until reset.

## Manual Mode

Use manual mode to turn the heater on and off directly.

### TO TURN ON AND OFF:

Use this key to toggle the heater on and off. The display will indicate the status.

### NOTE:

- If the room exceeds 90°, the heater will shut off.
- If left on, the heater will shut off after 6 hours.

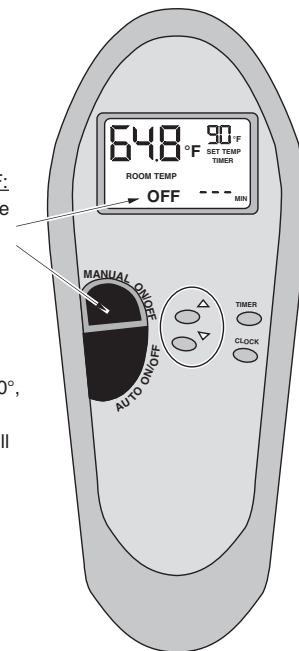

## Timed Mode

Timed mode allows you to turn the heater on for a pre-set period of time.

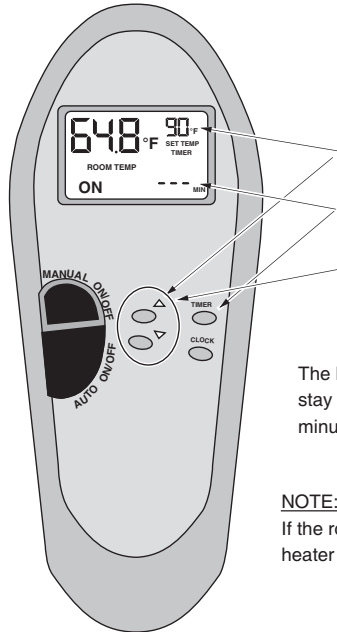

### TIMED OPERATION:

- Use the arrow keys to adjust the target temperature to 90°.
- Press the "TIMER" button - the " - - - " will start to flash.
- Use the arrow keys to set the number of minutes you would like the heater to stay on.

The heater will turn on and stay running for the number of minutes displayed.

### NOTE:

If the room exceeds 90°, the heater will shut off.

## CHILD PROOF FEATURE:

The child proof switch allows for the remote to be "protected" against undesired use.

This is the "Child Proof" Switch

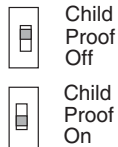

The child proof switch disables the buttons on the front of the remote. Thermostat and timed functions remain operational.

The words "Child Proof" appear here when this features is turned on.

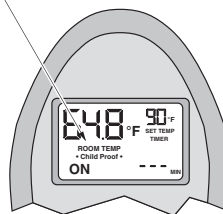

### Back of Transmitter

To over-ride the child-proof feature, press the up and down buttons in the following order:

- UP ▲  
 DOWN ▼  
 DOWN ▼  
 UP ▲  
 DOWN ▼

Press these buttons

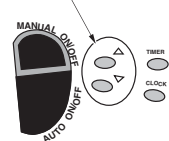

## OPERATION WITH DEAD BATTERIES

If the heater is on and the batteries in the remote go dead, the heater will turn off after 6 hours. To operate the heater, use the switch to turn the heater on and off.

If the heater is on and the batteries in the receiver go dead, the heater will turn off. To operate the heater, use the switch to turn the heater on and off.

## REPLACING THE BATTERIES

Follow the instructions on page 3 of the installation instructions to replace the batteries.